

NOTE:

1.MATERIAL:

- 1-1 HOUSING: LCP WITH 30% GF, UL 94V-0, BLACK COLOR
- 1-2 TERMINAL: COPPER ALLOY
- 1-3 SHELL: STEEL ALLOY

2.PLATING:

- 2-1 TERMINAL:
SEE TABLE GOLD PLATED ON CONTACT AREA,
2.54 μm [100 $\mu\text{''}$] MIN. MATTE-TIN ON SOLDER TAIL,
WITH ENTIRE CONTACT UNDERPLATED 1.27 μm [50 $\mu\text{''}$] MIN. NICKEL.
- 2-2 SHELL: OVERALL 1.27 μm [50 $\mu\text{''}$] MIN. NICKEL PLATED

3.ELECTRICAL PERFORMANCE:

- 3-1 CONTACT RESISTANCE: INITIAL CONTACT RESISTANCE
EXCLUDING CONDUCTOR RESISTANCE: 10 MILLIOHMS MAX.
- 3-2 DIELECTRIC STRENGTH: UNMATED CONNECTORS APPLY 500V AC
MATED CONNECTOR APPLY 300V AC
- 3-3 INSULATION RESISTANCE: 100 MEGAOHMS MIN. (UNMATED)
10 MEGAOHMS MIN. (MATED)

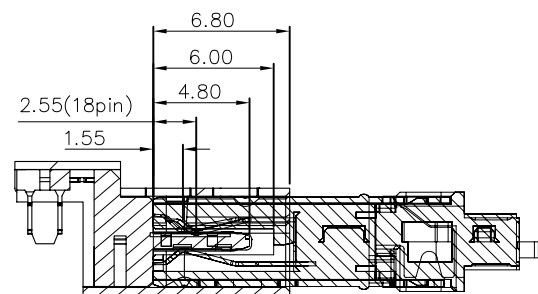
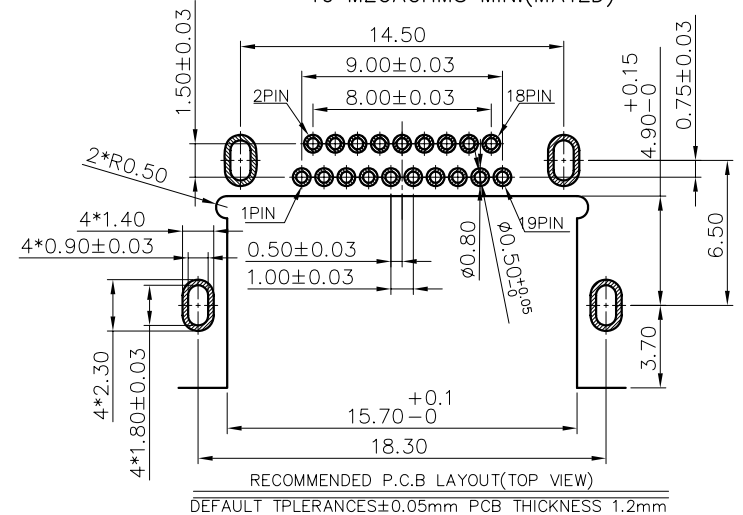
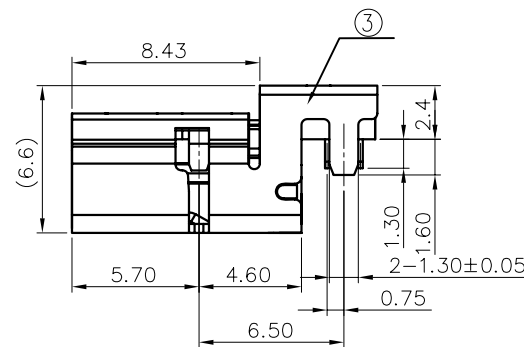
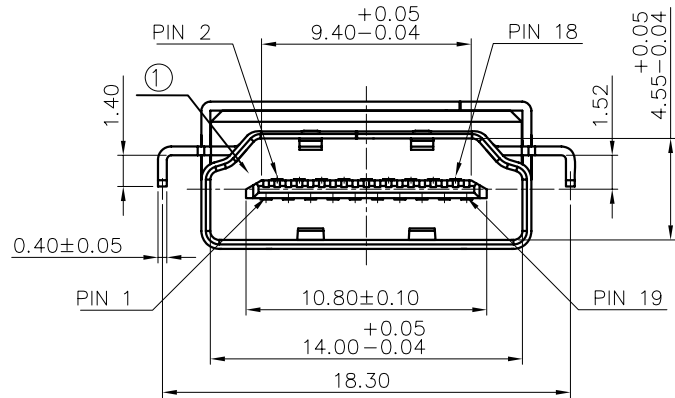

公母头对插图示

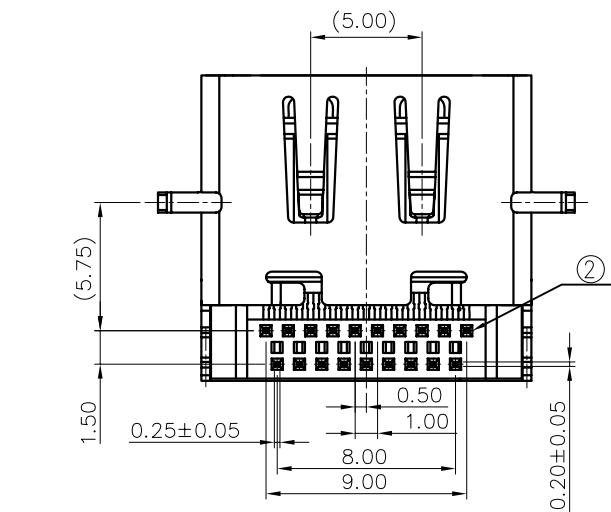

RoHS2+HF	SEE SHEET 3 OF 3	5u''	16-A1931-2A03-0
		G/F	16-A1931-1A03-0
GP TYPE	SEE SHEET 2 OF 3	5u''	16-A1930-2A03-0
	PACKING DRAWING	G/F	16-A1930-1A03-0
	MIN. GOLD THICKNESS		PART NUMBER

						TOLERANCES UNLESS OTHERWISE SPECIFIED		TITLE HDMI A TYPE FEMALE 19PIN H=6.6mm CH=-1.52mm. REC. RVS. DIP. TYPE(BDH-12)		UNIT mm
						X. ±0.50		ORIGINAL DATA		
						X.X ±0.30		04-29'16		
						X.XX ±0.20		DWN. Hongrui		PART NO.
						X.XXX ±0.15		CHK. Jimmy		SCALE 1:1
						ANGEL ±3'		APVD. Kevin		SIZE A3
B	ADD PACKING	N1711518	Xinye		09-01'16	MATERIAL SEE NOTES		DWG. NO. C-16-A193X		REV. B
A	FIRST RELEASED	N1608435	Hongrui	Jimmy	Kevin	FINISH SEE NOTES		SHEET 1 OF 3		
REV.	DESCRIPTION	ECN NO.	DWN.	CHK.	APVD.	DATE				

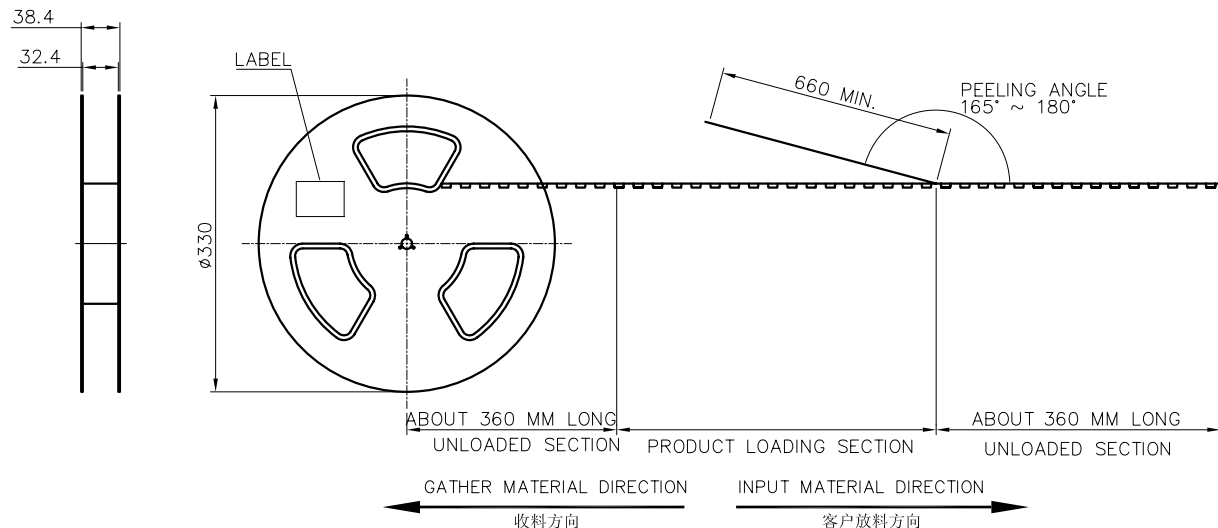

NOTE:

1. MATERIAL:
 BOX: FIBREBOARD, CORRUGATED, DOUBLE WALL.
 TAPE: POLYSTYRENES, WHITE COLOR.
 REEL: POLYSTYRENES, BLUE COLOR.
 BAG: POLYETHYLENE,
2. PEELING STRENGTH: 0.1 ~ 1.5 N (10 ~ 150 GRAMS)
3. PEELING SPEED: 300 mm/min.
4. EACH BAG SHALL BE INCLUDED DESICCANT.

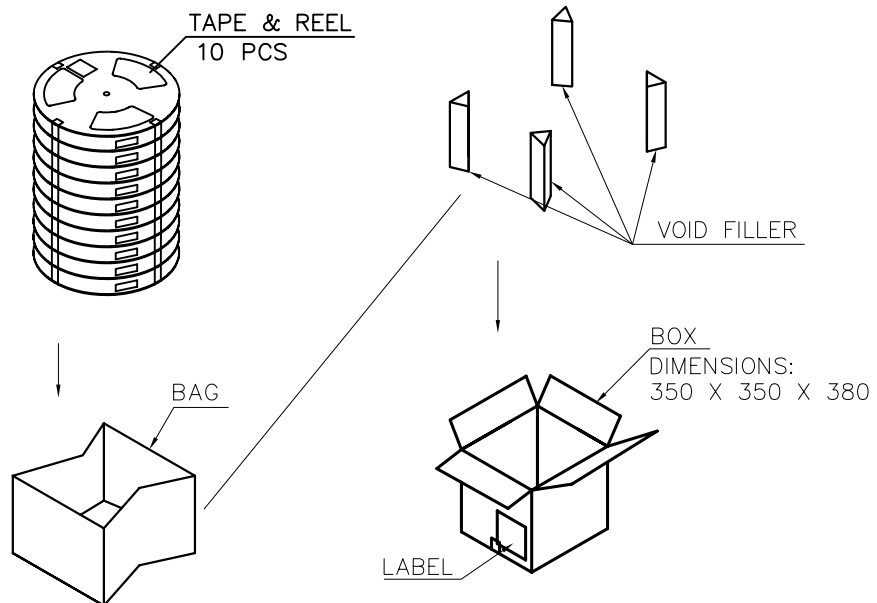
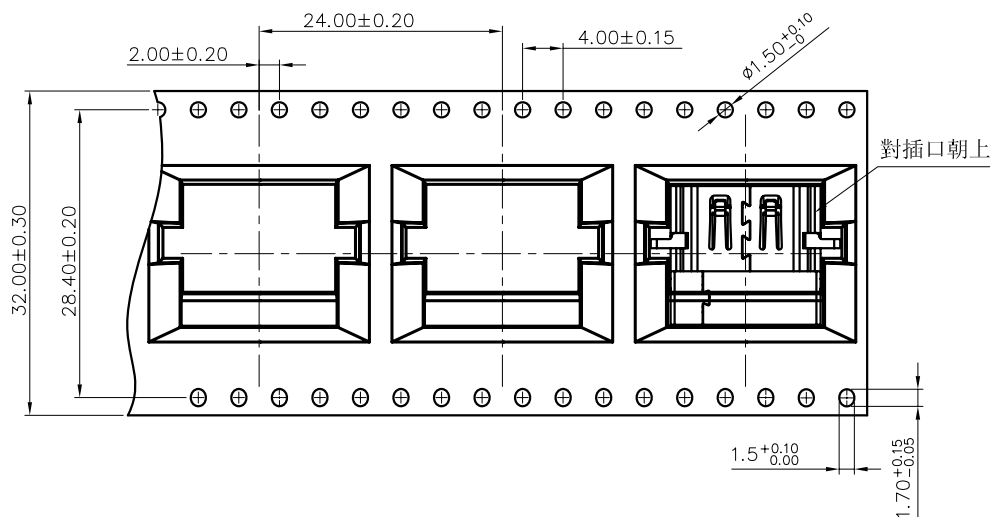

350	10	3500	--KG	--KG
PCS/ TAPE	REELS/ BOX	QUANTITY	GROSS WEIGHT	NET WEIGHT

							TOLERANCES UNLESS OTHERWISE SPECIFIED		TITLE HDMI A TYPE FEMALE 19PIN H=6.6mm CH=-1.52mm. REC. RVS. DIP. TYPE(BDH-12)		UNIT mm	
							X.	±0.50	ORIGINAL DATA			
							X.X	±0.30	04-29'16			
							X.XX	±0.20	DWN. Hongrui			
							X.XXX	±0.15	CHK. Jimmy			
							ANGEL	±3'	APVD. Kevin			
B	ADD PACKING	N1711518	Xinye			11-28'17	MATERIAL	PART NO.		SCALE	SIZE	REV.
A	FIRST RELEASED	N1608435	Hongrui	Jimmy	Kevin	09-01'16	SEE NOTES	SEE NOTE		1:1	A3	B
REV.	DESCRIPTION	ECN NO.	DWN.	CHK.	APVD.	DATE	FINISH	DWG. NO.			SHEET	
							SEE NOTES	C-16-A193X			2 of 3	

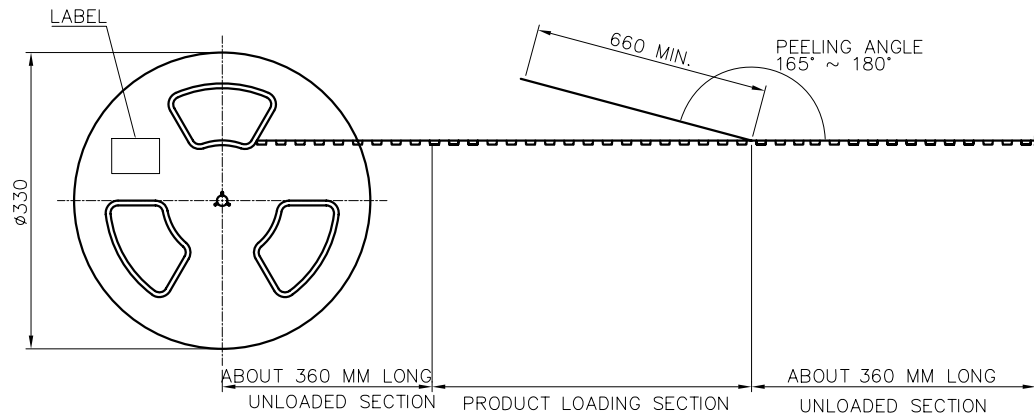
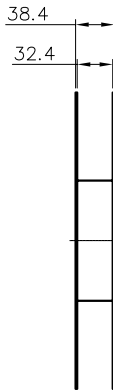

NOTE:

- MATERIAL:
 BOX: FIBREBOARD, CORRUGATED, DOUBLE WALL.
 TAPE: POLYSTYRENES, WHITE COLOR.
 REEL: POLYSTYRENES, BLUE COLOR.
 BAG: POLYETHYLENE,
- PEELING STRENGTH: 0.1 ~ 1.5 N (10 ~ 150 GRAMS)
- PEELING SPEED: 300 mm/min.
- EACH BAG SHALL BE INCLUDED DESICCANT.

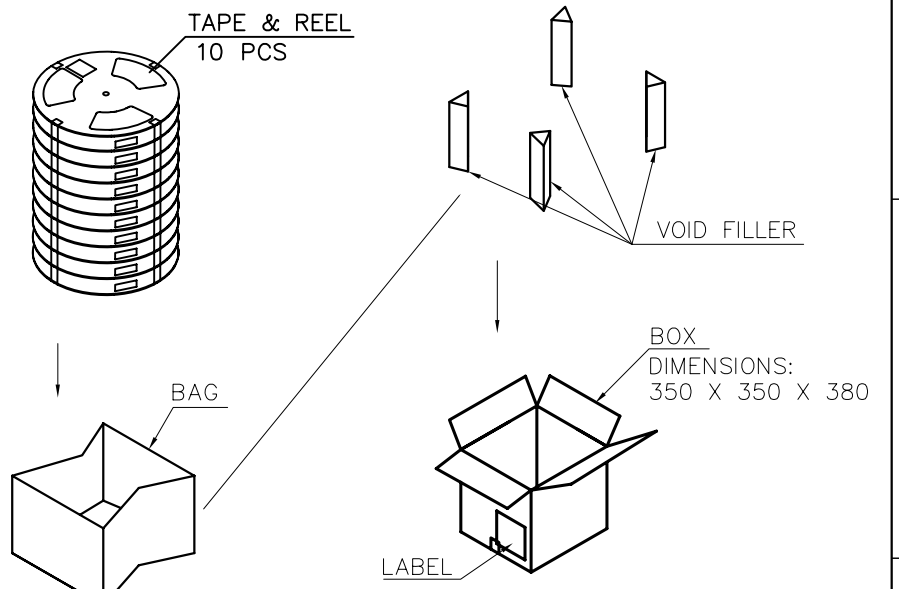
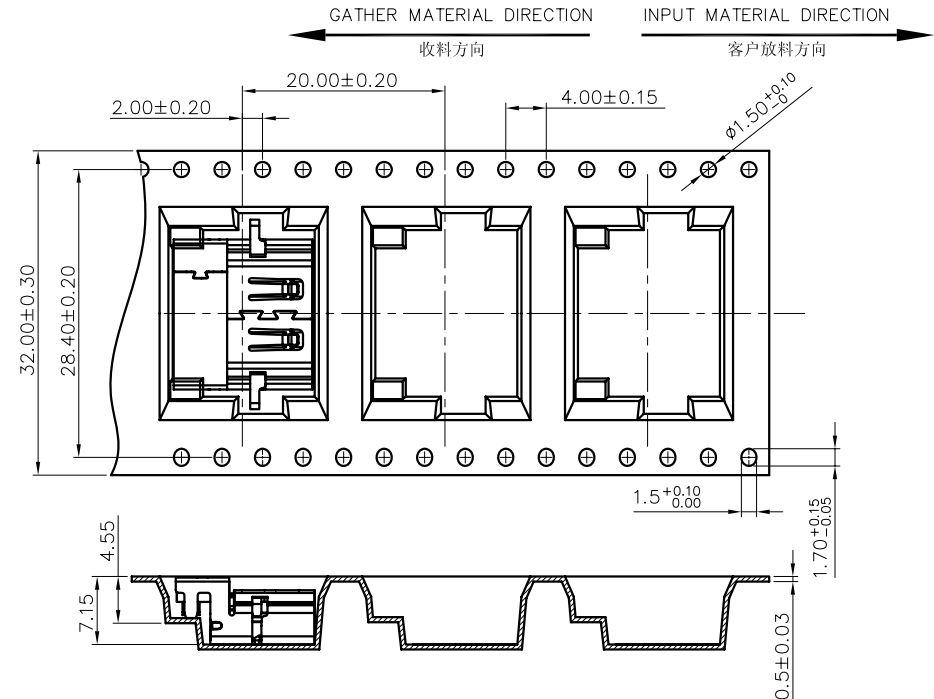

350	10	3500	--KG	--KG
PCS/ TAPE	REELS/ BOX	QUANTITY	GROSS WEIGHT	NET WEIGHT

						TOLERANCES UNLESS OTHERWISE SPECIFIED	TITLE HDMI A TYPE FEMALE 19PIN H=6.6mm CH=-1.52mm. REC. RVS. DIP. TYPE(BDH-12)		UNIT mm	
						X. ±0.50	ORIGINAL DATA			
						X.X ±0.30	04-29'16			
						X.XX ±0.20	DWN. Hongrui	PART NO.	SCALE 1:1	SIZE A3
						X.XXX ±0.15	CHK. Jimmy	SEE NOTE		REV. B
						ANGEL ±3'	APVD. Kevin	DWG. NO. C-16-A193X		SHEET 3 OF 3
REV.	DESCRIPTION	ECN NO.	DWN.	CHK.	APVD.	DATE	FINISH SEE NOTES			
B	ADD PACKING	N1711518	Xinye			11-28'17	MATERIAL SEE NOTES			
A	FIRST RELEASED	N1608435	Hongrui	Jimmy	Kevin	09-01'16	SEE NOTES			