

DATE CODE:
YYMMDD
(YY-YEAR
MM-MONTH
DD-DAY)

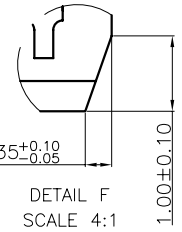

NOTES:
1.MATERIAL:
1-1 HOUSING:LCP BALCK UL94V-0
1-2 TERMINAL:COPPER ALLOY,0.20 THICKNESS.
1-3 SHELL:COPPER ALLOY,0.50 THICKNESS.
2.PLATING:
CONTACT: GOLD(SEE TABLE)PLATING ON CONTACT AREA, GOLD FLASH ON SOLDER TAIL, WITH ENTIRE CONTACT UNDERPLATING 1.27μm[50μ"] MIN. NICKEL.
SHELL: 1.27μm[50μ"] MIN. NICKEL PLATING.
3.ELECTRICAL PERFORMANCE:
3-1 CONTACT RESISTANC:INITIAL CONTACE RESISTANCE EXCLUDING CONDUCTOR RESISTANCE:10 MILLIOHMS MAX.
3-2 DIELECTRIC STRENGTH:UNMATED CONNECTORS APPLY 500V AC MATED CONNECTOR APPLY 300V AC
3-3 INSULATION RESISTANCE:100 MEGAOHMS MIN.(UNMATED) 10 MEGAOHMS MIN.(MATED)

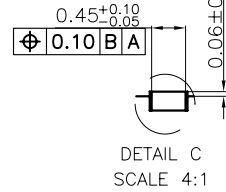
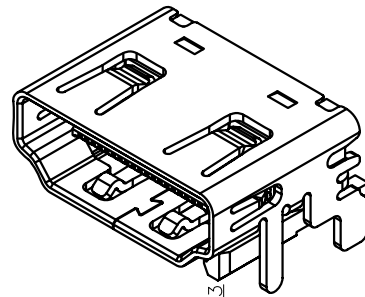
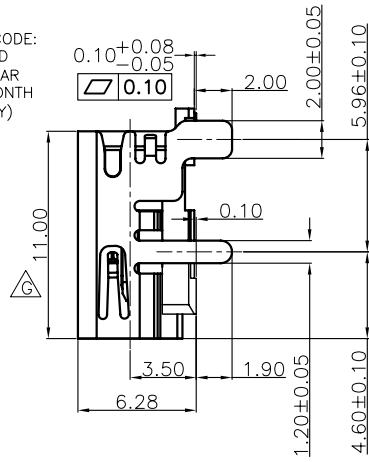
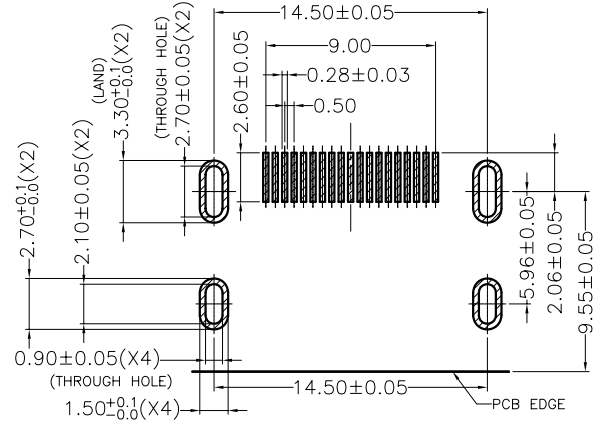
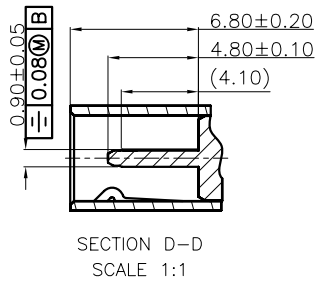
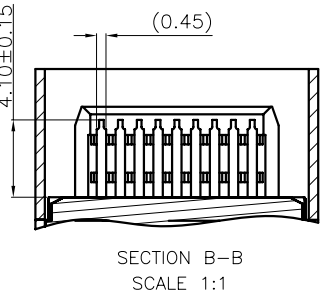
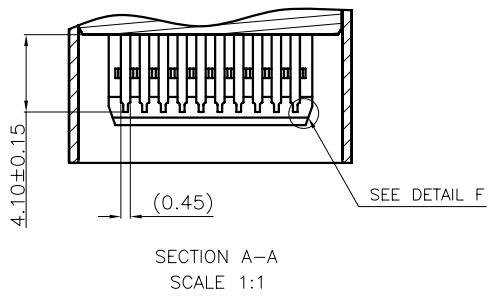
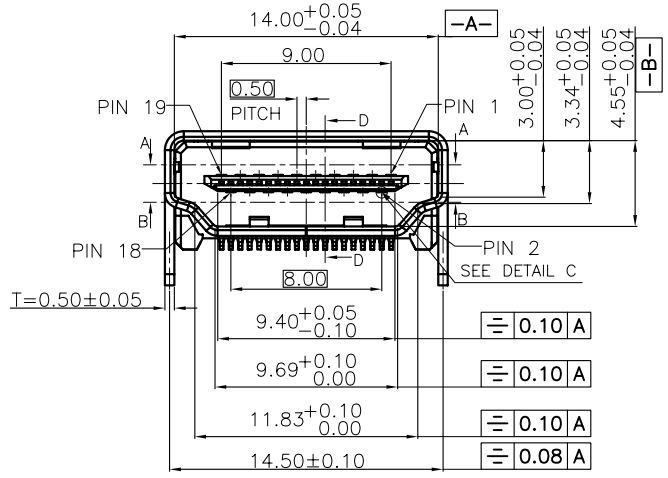

RECOMMENDED PCB LAYOUT THICKNESS = 1.6 mm
TOLERANCE = ±0.03
(TOP VIEW)

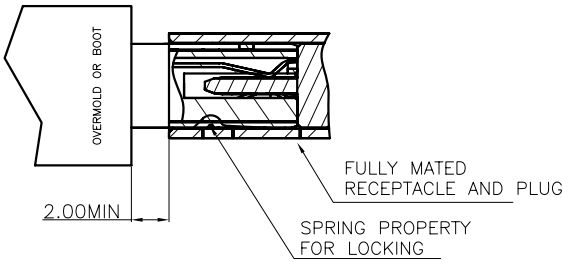

RoHS2+HF	30u"	1165-14211-210
	G/F	1165-11211-210
GP TYPE	MIN. GOLD THICKNESS	PART NUMBER

REV.	DESCRIPTION	ECN NO.	DWN.	CHK.	APVD.	DATE
G	增加尺寸標示	N1801025	Xinye			01-18'18
F	修改尺寸公差標示	N1601040	Zongshur	Jimmy	Kevin	01-22'16
E	增加電鍍規格	N1512482	Zongshur	Jimmy	Kevin	12-04'15
D	增加尺寸標注	N1503075	Zhouyu	Jimmy	Kevin	03-04'15
C	更換圖框	--	KEN	Daniel	Daniel	02-27'12
B	modify spring width and distance	--	KEN	Daniel	Daniel	11-08'11

TOLERANCES UNLESS OTHERWISE SPECIFIED	X. ±0.50
	X.X ±0.30
	X.XX ±0.20
	X.XXX ±0.15
	ANGEL ±3°
MATERIAL	SEE NOTE
FINISH	SEE NOTE

TITLE	HDMI FEMALE R/A & SMT TYPE 19PIN (HDMI-BSA SERIES)				UNIT	mm
ORIGINAL DATA	03-22'11				A	
DWN.	KEN	PART NO.	SCALE	SIZE	REV.	
CHK.	Daniel	SEE TABLE	1:1	A3	G	
APVD.	Daniel	DWG. NO.	C-1165-11211-21C	SHEET	1 OF 2	

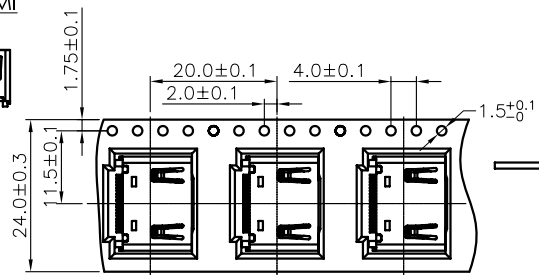
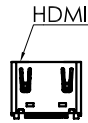

卷带时收料方向：焊脚朝左。

(保护带)

内箱标签

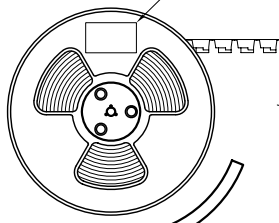

卷盘

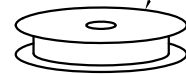

干燥剂

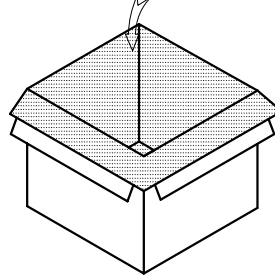

卷盘放置12层，在四个角落各放一袋干燥剂

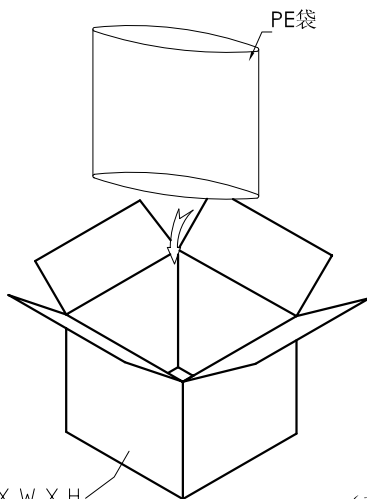

PE袋

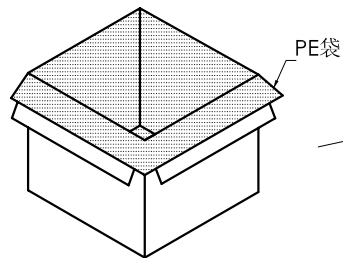

PE袋

用五行机带以“十”字形扎捆

(产品若为整个站板出货不需扎捆五行机带)

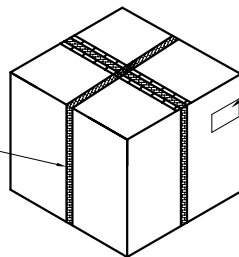

外箱标签

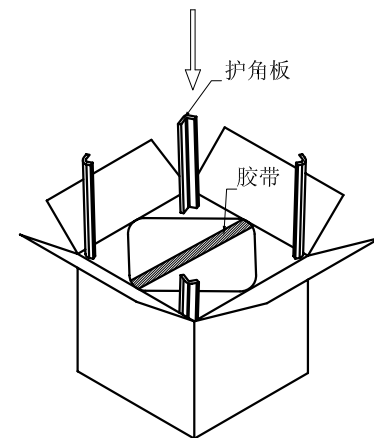

护角板

胶带

L X W X H
350mmX350mmX380mm

Notes:

1. 卷带中每位置放置一个产品,每卷卷带的两端各留约30cm;
2. 边放产品边用封胶带封口,1个卷盘放置350个产品;
3. 然后再卷一圈保护带,保护带最后重叠约50MM,用皱纹胶纸将其封住;
4. 每个卷盘外侧图示位置贴外箱标签;
5. 将PE袋套入外箱后,再将12个卷盘放入箱子,并在四个角各放入干燥剂一袋;
6. 外箱外侧以胶带封口,每个外箱外侧图示位置贴外箱标签;
7. 每个外箱装4200PCS;

350	12	4200	--KG	--KG
PCS/REEL	REEL/BOX	QUANTITY	GROSS WEIGHT	NET WEIGHT

G	增加尺寸标示	N1801025	Xinye			01-18'18	TOLERANCES UNLESS OTHERWISE SPECIFIED X.X ±0.50 X.XX ±0.30 X.XXX ±0.20 X.XXX ±0.15 ANGEL ±3'	TITLE HDMI FEMALE R/A & SMT TYPE 19PIN (HDMI-BSA SERIES)		UNIT mm		
F	修改尺寸公差标示	N1601040	Zongshun	Jimmy	Kevin	01-22'16		ORIGINAL DATA 03-22'11	tconn precision		A	
E	增加电镀规格	N1512482	Zongshun	Jimmy	Kevin	12-04'15	MATERIAL SEE Note	DWN. KEN	PART NO. SEE TABLE	SCALE 1:1	SIZE A3	REV. G
D	增加尺寸标注	N1503075	Zhouyu	Jimmy	Kevin	03-04'15		FINISH SEE Note	CHK. Daniel	DWG. NO. C-1165-11211-21C	SHEET 2 OF 2	
C	更换图框	--	KEN	Daniel	Daniel	02-27'12		APVD. Daniel				
B	modify spring width and distance	--	KEN	Daniel	Daniel	11-08'11						
REV.	DESCRIPTION	ECN NO.	DWN.	CHK.	APVD.	DATE						